

# CLUTCH HOUSING AND TRANSAXLE CASE COMPONENTS ASSEMBLY

A6E511217010M02

1. Assemble in the order shown in the figure.

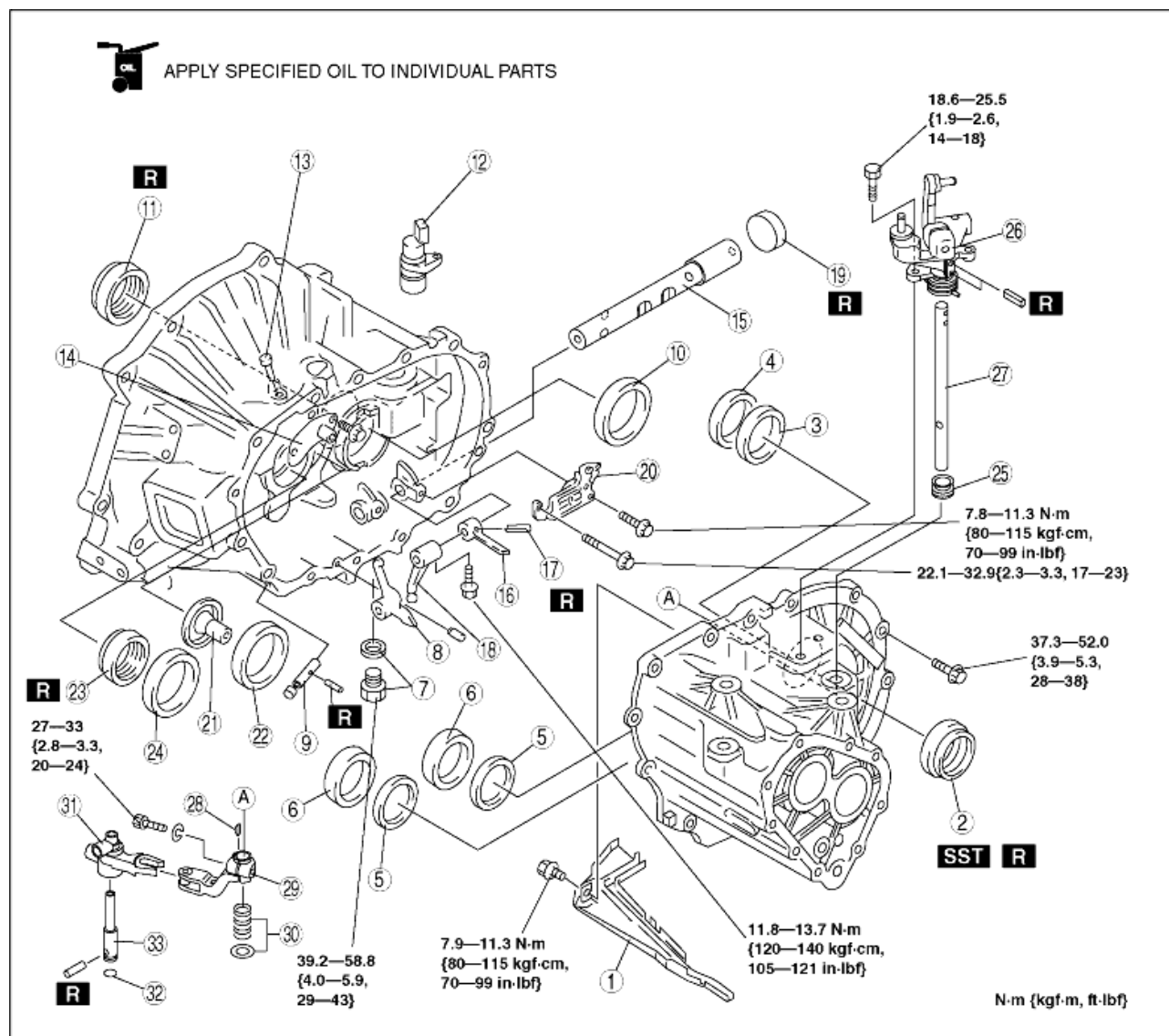

A6E5112M112

1	Oil passage
2	Oil seal (differential)
3	(See <a href="#">Oil Seal (Differential) Assembly Note</a> )
4	Adjustment shim(s)
5	Bearing race (differential)
6	(See <a href="#">Bearing Race (Differential) Assembly Note</a> )
7	Adjustment shim(s)
8	Bearing race (transaxle case)
9	(See <a href="#">Bearing Race (Transaxle Case) Assembly Note</a> )
10	Drain plug and washer
11	Reverse lever

9	Reverse lever shaft
10	Bearing race (differential) (See <a href="#">Bearing Race (Differential) Assembly Note</a> )
11	Oil seal (differential) (See <a href="#">Oil Seal (Differential) Assembly Note</a> )
12	Hole cover
13	Bleather
14	Bleather cover component
15	Control rod
16	Selector
17	Roll pin
18	Change arm
19	Sealing cap
20	Guide plate component
21	Funnel
22	Bearing race (secondary shaft)
23	Oil seal (primary shaft) (See <a href="#">Oil Seal (Primary Shaft) Assembly Note</a> )
24	Bearing race (primary shaft)
25	Boots
26	Shift lever component
27	Shift lever shaft
28	Key
29	Control end
30	Spring and washer
31	Clank component lever
32	O-ring
33	Crank lever shaft

### Oil Seal (Differential) Assembly Note

1. Apply transaxle oil to the new oil seal lip.
2. Install the oil seal using the **SST**.

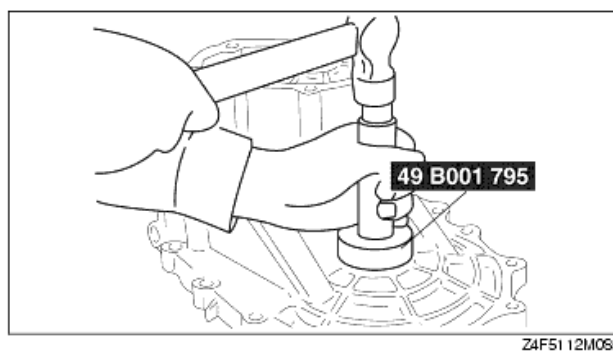

Z4F51 12M065

### Bearing Race (Differential) Assembly Note

1. Install the adjustment shim(s) and install the bearing race using a suitable pipe.

### Bearing Race (Transaxle Case) Assembly Note

1. Install the adjustment shim(s) and install the bearing race using a suitable pipe.

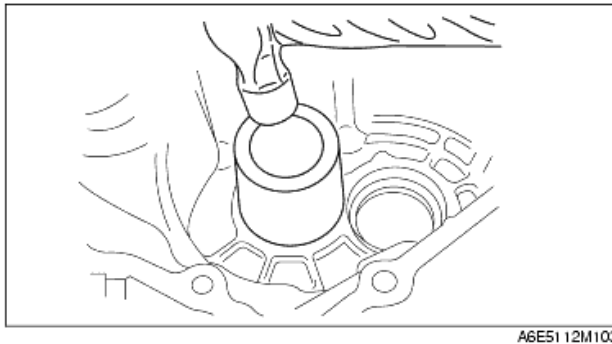

### Oil Seal (Change Rod Component) Assembly Note

1. Apply transaxle oil to the new oil seal lip.
2. Install the oil seal using a suitable pipe.

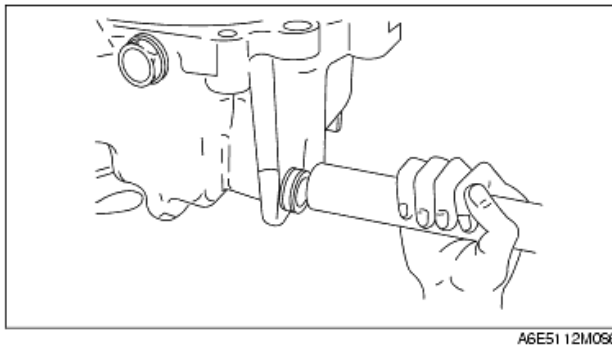

Outer diameter of pipe  
26.0 mm {1.02 in}

### Oil Seal (Primary Shaft) Assembly Note

1. Apply transaxle oil to outer circumference of the oil seal.
2. Install the new oil seal using a suitable pipe.

